

# DUCT AND IMMERSION BUILDING AUTOMATION TEMPERATURE SENSORS

Available up to 18" Probe Length, Thermistor or RTD Outputs

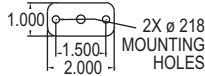
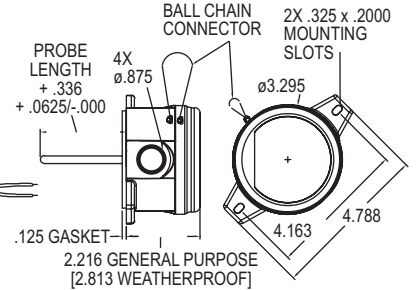
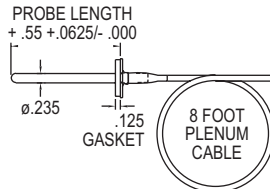
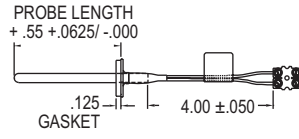
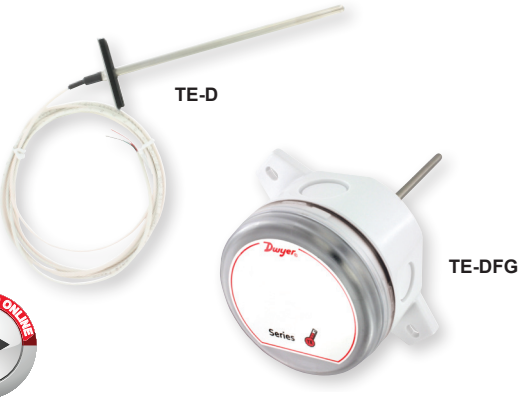
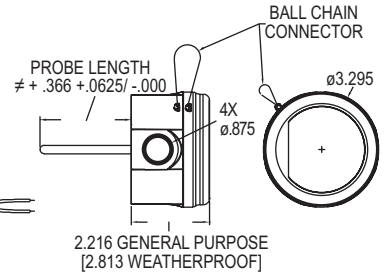
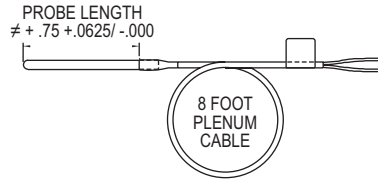
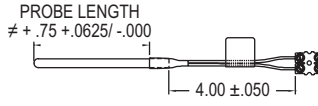

The Series TE Duct and Immersion Building Automation Temperature Sensors can be used to monitor air or water temperature throughout a building management system or an air handler unit. Duct or immersion options available with or without an enclosure.

**FEATURES/BENEFITS**

- Easy to mount external tab housing and flange options for duct applications
- 1/4 turn housing cover with chain to prevent dropping
- Multiple conduit knockouts for easy installation positioning
- 8' plenum rated cable option
- Terminal connector eliminates need for wire nuts

**APPLICATIONS**

- Building automation
- VAV temperature sensing
- Chiller or boiler loops
- AHU monitoring

**SPECIFICATIONS**

**Accuracy:** Thermistor temperature sensor:  $\pm 0.22^{\circ}\text{C}$  @  $25^{\circ}\text{C}$  ( $\pm 0.4^{\circ}\text{F}$  @  $77^{\circ}\text{F}$ ); RTD temperature sensor: DIN class A:  $\pm 0.15^{\circ}\text{C}$  @  $0^{\circ}\text{C}$  ( $\pm 0.28^{\circ}\text{F}$  @  $32^{\circ}\text{F}$ ).  
**Temperature Limits:** Operating:  $-40$  to  $302^{\circ}\text{F}$  ( $-40$  to  $150^{\circ}\text{C}$ ).  
**Sensor Curves:** See page reference 1 below.  
**Cable Rating:** Plenum option includes UL listed plenum cable.  
**Housing Material:** Meets UL, 94 V-0 polycarbonate plastic.  
**Housing Rating:** NEMA 4X (IP66) (DFW, IBW only).  
**Weight:** 5.3 oz (150.3 g).  
**Agency Approvals:** Meets the technical requirements of EU Directive 2011/65/EU (RoHS II).

| MODEL CHART            |    |  |                                 |                                  |   |                  |                |   |
|------------------------|----|--|---------------------------------|----------------------------------|---|------------------|----------------|---|
| Example                | TE | -DFN                                   | -A                              | 04                               | 4 | 8                | -00            | TE-DFN-A0448-00   |
| Series                 | TE |  |                                 |                                  |   |                  |                | Temperature sensor  |
| Mounting Configuration |    | DFN<br>DFG<br>DFW<br>IBN<br>IBG<br>IBW |                                 |                                  |   |                  |                | Duct mount probe only<br>Duct mount probe in general purpose housing<br>Duct mount probe in NEMA 4X housing<br>Immersion probe only<br>Immersion probe in general purpose housing<br>Immersion probe in NEMA 4X housing |
| Sensor Type            |    |  | A<br>B<br>C<br>D<br>E<br>F<br>Q |                                  |   |                  |                | 10k $\Omega$ type III thermistor<br>10k $\Omega$ type II thermistor<br>3k $\Omega$ thermistor<br>Pt100 $\Omega$ RTD<br>Pt1000 $\Omega$ RTD<br>20k $\Omega$ thermistor<br>10k $\Omega$ type III with 11k $\Omega$ shunt  |
| Probe Length           |    |  |                                 | 25<br>04<br>06<br>08<br>12<br>18 |   |                  |                | 2.5"<br>4"<br>6"<br>8"<br>12"<br>18" (DFN/DFG only)   |
| Probe Diameter         |    |  |                                 |                                  | 4 |                  |                | 1/4" double encapsulated  |
| Termination            |    |  |                                 |                                  |   | 3<br>4<br>7<br>8 |                | 4" leads with spade connectors<br>4" leads<br>8' plenum rated cable with spade connectors<br>8' plenum rated cable  |
| Fittings               |    |  |                                 |                                  |   |                  | 00<br>12<br>14 | None (probe only)<br>1/2" NPT compression fitting<br>1/4" NPT compression fitting   |

●Resistance vs. Temperature Table: See page 146 (Series TE-OND/RND/OSA)